



Lifting stations

Ecolift[®] - the clever alternative to a classical lifting station

Lifting stations for interior installation

Lifting stations for exterior installation



Submersible pumps

Lift wastewater

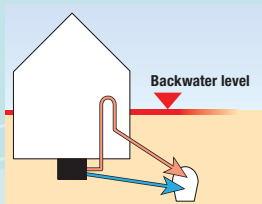

Ecolift® uses the natural gradient to the sewer and only uses the pressure pipe through the backwater level for discharge during backwater events.







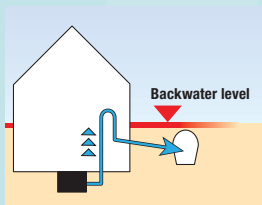

-  **Ecolift® wastewater lifting system** 38
for underground installation
-  **Ecolift® wastewater lifting system** 38
for installation in an exposed wastewater pipe



Lifting wastewater to the sewer system







-  **Wastewater lifting station Aqualift® F** 42
for underground installation
-  **Lifting station Aqualift® F Mono / Duo** 44
for above ground installation
-  **Wastewater lifting station Aqualift® S Mono / Tronic / Duo** 46
for interior installation
-  **Twin lifting station** 48
for interior installation
-  **Wastewater lifting station Minilift** 48
for underground/above ground installation
-  **Lifting station Aqualift® F Duo XXL** 50
for free installation in frost free areas

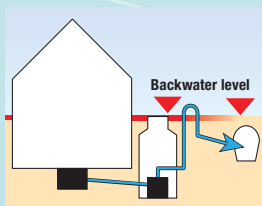

Outdoor pump installation frees up indoor living space



-  **Lifting station Aqualift® F** 52
in Komfort inspection chamber system
Ø 1000
-  **Pumping station Aqualift® F** 54
in Komfort inspection chamber system
Ø 1000
-  **Pumping station Aqualift® S** 56
in Komfort inspection chamber system
Ø 600
-  **Pumping station Aqualift® S** 57
in Komfort inspection chamber system
Ø 1000



Mobile pump used for lawn / garden watering

- Submersible pump KTP 1000** 60
for wastewater without sewage
- Submersible pump KTP 500** 60
for wastewater without sewage
- Submersible pump KTP 300** 61
for wastewater without sewage

Ecolift® wastewater lifting system for interior installation



Ecolift® wastewater lifting system for interior installation

Lifting stations for interior installation

Lifting stations for exterior installation

Submersible pumps

KESSEL - typical advantages

World innovation *Ecolift*® – the alternative to a

Ecolift® uses the gradient to the sewer

NEW

for wastewater with or without sewage

First pumping station for inclined pipes

- As inexpensive as a backwater valve, as safe as a pumping station!



Until now:

Lifting despite gradient to the sewer

Disadvantages in normal mode:

- Pump always required
- Higher energy & wear and tear costs
- Pump noises
- No drainage during power loss
- No drainage during pump breakdown
- Loss of living space due to the pump sump/ maintenance room acc. to DIN EN 12056, Part 4

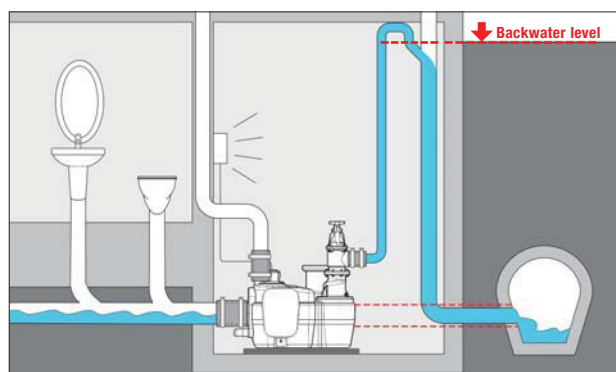

In the future:

Ecolift® where there is a natural gradient to the sewer

Advantages in normal mode:

- No pump operation
- No energy requirements
- No pumping noises
- Wastewater disposal uses the natural gradient
- Wastewater disposal even after power failure
- No interruption in operation even if pump fails

Advantages in an emergency: In case of a flooded basement

- Cellar draining via the integrated drainage function
- In the event of additional backwater, wastewater disposal is via the backwater loop
- The backwater valve and additional pressure pipe provide protection from backwater

1. Normal mode:

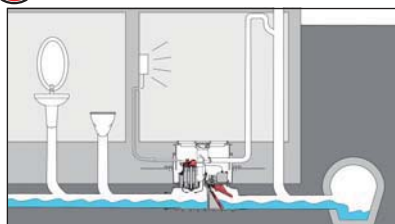

2. Backwater:

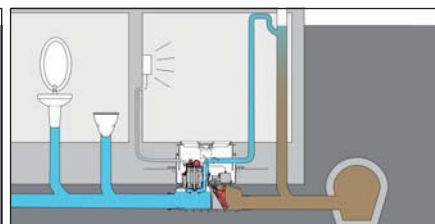
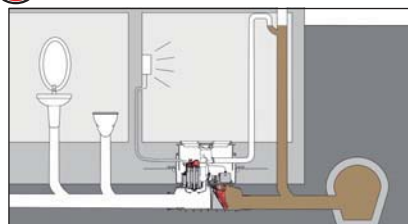

classical lifting station with gravity sloped drainage

- Installation body with only 9 mm gradient for installation in a concrete slab / floor or for fitting into an exposed pipeline.



- Removable inlet/outlet connections also in Ø 200 Socket/spigot for customized connections, variable inlet and outlet sizes available



- Installation in waterproof concrete Gasket set to prevent groundwater infiltration (accessory)

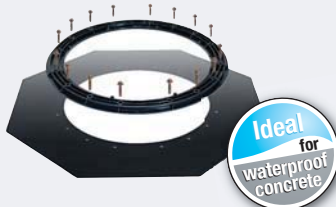

Ideal for waterproof concrete

- Stainless steel backwater flap to keep rats and rodents out (accessory)



On-call service thanks to comprehensive customer services with 24 h emergency service within Germany and large parts of Europe

- Plug & play control unit with self-diagnosis system SDS for maximum safety



Assembly even possible without a qualified electrician

- New Komfort version with display for operating state and servicing instructions as well as connection option for building management system.



- Fast and straightforward servicing



- Covers can be individually tiled No open pump sump or maintenance space required per EN 12056, Part 4 - means more living space.



- Performance diagram Ecolift®

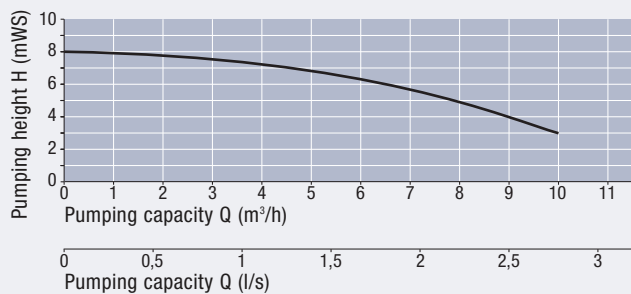

- Fully open pipe passage with open backwater flap during normal conditions, flap is automatically closed with motor during backwater

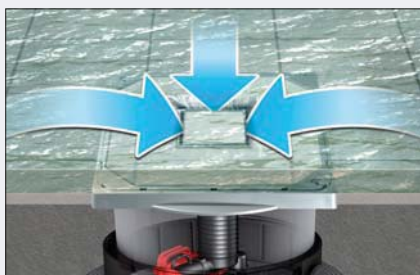

- Integrated drain function to drainage surface water Continual drainage even in the event of a catastrophe

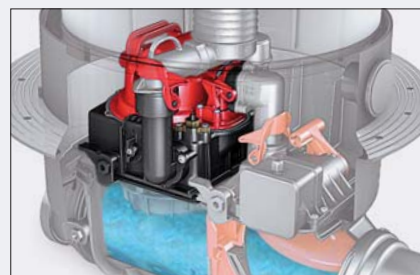

- Pump head outside the flow area Offers full channel passage
- Increased pump volume

Products see page 38

Ecolift® wastewater lifting system for wastewater with or without sewage for underground installation

Illustration and dimensioned drawing

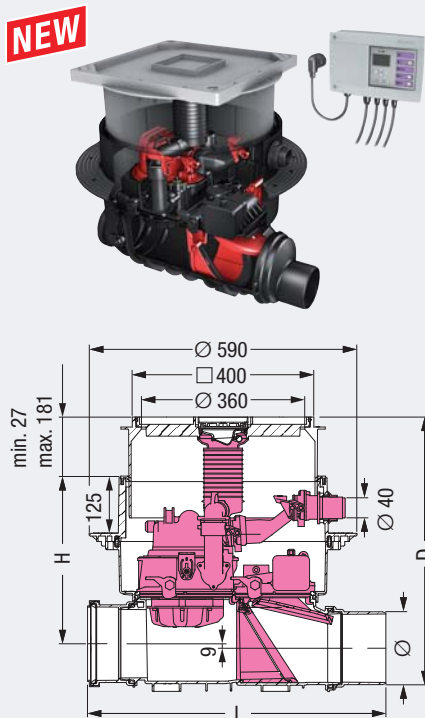

Installation area 750 x 750 mm

Article description

Ecolift® wastewater lifting system for pipes with natural gradient to the sewer

The alternative to a classical lifting station

For wastewater with or without sewage, for installation in a concrete slab/floor.

Installation depth (D) 486 mm to 640 mm

Including installation set and cover plate with integrated drain function for surface water drainage. With integrated pump and a backwater valve locked by a motor. During normal conditions, the pipe cross section is open, in the case of backwater the valve is closed and locked completely automatically. During the backwater period, soiled water is drained using a pump with chopping device, via a pressure pipe \varnothing 40 mm over the backwater level. Plug-in control and warning unit with display, self-diagnosis system (SDS) and battery buffering for maximum safety, with logbook (diary function) for reading out the past operating states.

Power cable / cable length: 5 m
Mains voltage/frequency: 230 V AC / 50 Hz
Protective rating: IP 54 (switch unit)
Protective rating: IP 68 (motor)

\varnothing 110	L: 642 mm	H: 394 mm
\varnothing 125	L: 645 mm	H: 387 mm
\varnothing 160	L: 656 mm	H: 370 mm
\varnothing 200	L: 720 mm	H: 348 mm

Approval: pending

\varnothing^*

Art. #

With recessed cover for on-site tiling and drain (X)

\varnothing 110	21 100X
\varnothing 125	21 125X
\varnothing 160	21 150X
\varnothing 200	21 200X

With black cover and drain (S)

\varnothing 110	21 100S
\varnothing 125	21 125S
\varnothing 160	21 150S
\varnothing 200	21 200S

Ecolift® wastewater lifting system for wastewater with or without sewage for installation in an exposed wastewater pipe

Illustration and dimensioned drawing

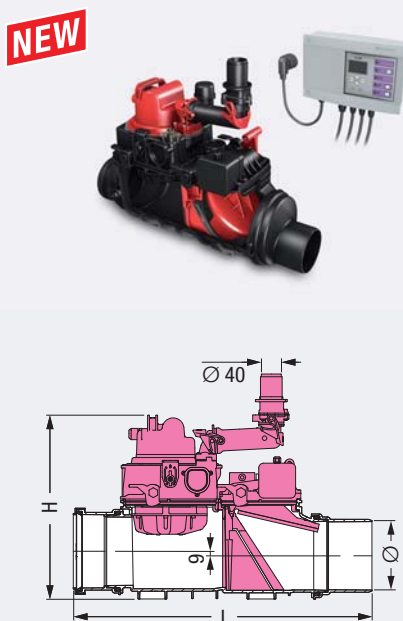

Article description

Ecolift® wastewater lifting system for pipes with natural gradient to the sewer

The alternative to a classical lifting station

For wastewater with or without sewage, for installation in an exposed wastewater pipe

With protective cover. With integrated pump and a backwater valve locked by a motor. During normal conditions, the pipe cross section is open, in the case of backwater the valve is closed and locked completely automatically. During the backwater period, soiled water is drained using a pump with chopping device, via a pressure pipe over the backwater level. Plug-in control and warning unit with display, self-diagnosis system (SDS) and battery buffering for maximum safety, with logbook (diary function) for reading out the past operating states.

Power cable / cable length: 5 m
Mains voltage/frequency: 230 V AC / 50 Hz
Protective rating: IP 54 (switch unit)
Protective rating: IP 68 (motor)

\varnothing 110	L: 642 mm	H: 405 mm
\varnothing 125	L: 645 mm	H: 405 mm
\varnothing 160	L: 656 mm	H: 405 mm
\varnothing 200	L: 720 mm	H: 405 mm

Approval: pending

\varnothing^*

Art. #

\varnothing 110	21 100
\varnothing 125	21 125
\varnothing 160	21 150
\varnothing 200	21 200

* \varnothing = Outer Diameter

Accessories

Illustration and dimensioned drawing	Article description	Ø*	Art. #
	<p>Gasket set for installation in waterproof concrete consisting of: Counter flange made of polymer, incl. screws, elastomer waterproof membrane in NK/SBR Ø 800 mm</p>	-	83 023
	<p>Extension section with flange made of polymer, H = 180 mm, incl. gasket For gasket set Art. # 83 023</p>	-	83 071
	<p>Extension section made of polymer, H = 180 mm, incl. gasket</p>	-	83 070
	<p>Pressure pipe set Incl. 5 m pressure pipe hose Ø 40, Adaptor with pipe clamp</p>	Ø 40	28 040
	<p>Potential-free contact Change-over contact 42 V / 0.5 A; Additional circuit board with a potential-free contact e.g. for connecting control unit to BMS (Building Management System).</p>	-	80 072
	<p>Audible alarm Electronic audible alarm (continuous tone) with connection cable 20 m Minimum current consumption 5 - 25 mA, audible tone 4.7 KHz - 90 dB, large voltage range 6 - 24 V DC; Dimension Ø 31 x 15 mm.</p>	-	20 162
	<p>Cover plate with drain</p> <p><input type="checkbox"/> recessed for on-site tiling, grey, for tile thicknesses of 18 mm, Class A 15</p> <p><input type="checkbox"/> with integrated grating, black, Class A 15</p>	-	83 045
	<p>Multistop as an odour, foam, rodent and insect stop for Art. # 83 045 and 83 046</p>	-	43 500
	<p>Hair filter made of polymer for Art. # 83 045 and 83 046</p>	-	43 700



Accessories

Illustration and dimensioned drawing	Article description	Ø*	Art. #
	<p>Cover plate surface water tight, made of polymer, incl. gasket Art. # 173-145</p> <p><input type="checkbox"/> black, Class A 15</p> <p><input type="checkbox"/> recessed for on-site tiling, grey, for tile thicknesses of 18 mm, Class A 15</p>	-	<p>83 050</p> <p>83 052</p>
	<p>Upper section Size 220, made of polymer, H = 180 mm, height adjustable</p>	-	83 061
<p>NEW</p> 	<p>Inlet / Outlet</p> <p><input type="checkbox"/> Spigot</p> <p><input type="checkbox"/> Socket</p>	<p>Ø 110</p> <p>Ø 125</p> <p>Ø 160</p> <p>Ø 200</p> <p>Ø 110</p> <p>Ø 125</p> <p>Ø 160</p> <p>Ø 200</p>	<p>83 081</p> <p>83 082</p> <p>83 083</p> <p>83 084</p> <p>83 085</p> <p>83 086</p> <p>83 087</p> <p>83 088</p>
<p>NEW</p> 	<p>Ecolift® -Replacement pump Cable length 5 m</p> <p>Cable extension set (for pump) Cable length 10 m</p>	-	<p>28 351</p> <p>80 891</p>
<p>NEW</p> 	<p>Drive motor Ecolift® Cable length 5 m</p> <p>Cable extension set (for motor) Cable length 10 m</p>	-	<p>80 076</p> <p>80 890</p>
<p>NEW</p> 	<p>Optical probe - Triple adaptor set Cable length 5 m</p> <p>Adaptor set for optical probe installation</p> <p>Cable extension set (for probe) Cable length 10 m</p>	-	<p>80 888</p> <p>80 892</p> <p>80 889</p>

Lifting stations for interior installation



Ecolift® wastewater lifting system
for interior installation

Lifting stations
for interior installation

Lifting stations
for exterior installation

Submersible pumps

Wastewater lifting station *Aqualift® F* for wastewater with or without sewage for underground installation

Illustration and dimensioned drawing

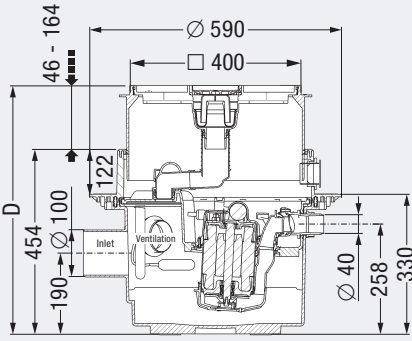
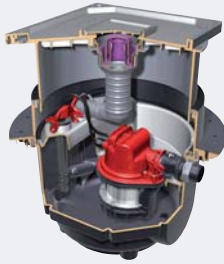

Article description

Wastewater lifting station *Aqualift® F* for wastewater with or without sewage for underground installation / in a concrete slab/floor

Installation depth (D) 500 mm to 618 mm
for covers with integrated odour traps
(sealing water height 50 mm)

Installation depth (D) 481 mm to 618 mm
for covers with Multistop as odour trap

With side inlet \varnothing 110, integrated outlet pipe, odour trap.
With telescopic extension section for continuous height
and level adjustment, recessed cover made of polymer,
Class A 15, with moisture protective sealing flange,
with single removable pump, with integrated macerator
and float control, **with integrated backwater flap**.
Ventilation connection \varnothing 75

Pressure connection: 1½ inch outer thread or
Pressure pipe \varnothing 40 mm for PVC glued connection
or pressure pipe set.

Installation area 800 x 800 mm

CE Certification no. Z-53.2-484

Pressure connection

Art.

Single station with a float, Removable pump

\varnothing 40 28300

Pumping height: max. 8 m.
Voltage: 230 V ~ 50 Hz.
Power cable: 5 m.
Intake power: 1.0 kW
Weight: approx. 25 kg

Optional:
Alarm (Art. # 20 221) for alarm
notification,
potential-free contact (Art. # 80 072),
audible alarm (Art. # 20 162)

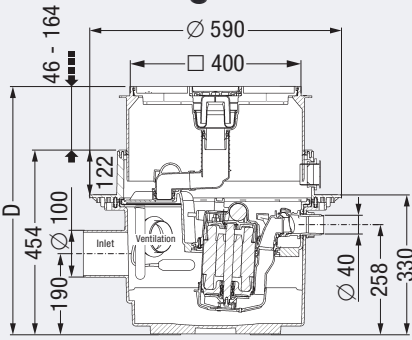
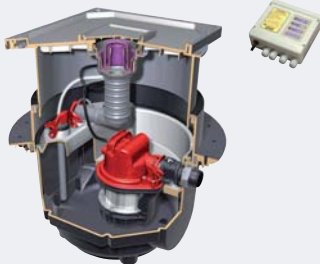

Wastewater lifting station *Aqualift® F Tronic Underground* for wastewater with or without sewage for underground installation / in a concrete slab/floor

Installation depth (D) 500 mm to 618 mm
for covers with integrated odour traps
(sealing water height 50 mm)

Installation depth (D) 481 mm to 618 mm
for covers with Multistop as odour trap

With side inlet \varnothing 110, integrated outlet pipe, odour trap.
With telescopic extension section for continuous height
and level adjustment, recessed cover made of polymer,
Class A 15, with moisture protective sealing flange,
with single removable pump, with integrated macerator
and float control, **with integrated backwater flap**.
Ventilation connection \varnothing 75

Pressure connection: 1½ inch outer thread or
Pressure pipe \varnothing 40 mm for PVC glued connection
or pressure pipe set.

Installation area 800 x 800 mm

CE Certification no. Z-53.2-484

Single station with SDS control unit (Self diagnosis system) for fully automated pump control, splash-proof (IP 54) Removable pump

\varnothing 40 28350

Pumping height: max. 8 m.
Voltage: 230 V ~ 50 Hz.
Power cable: 5 m.
Intake power: 1.0 kW
Weight: approx. 25 kg

Optional:
potential-free contact (Art. # 80 072),
Audible alarm (Art. # 20 162)

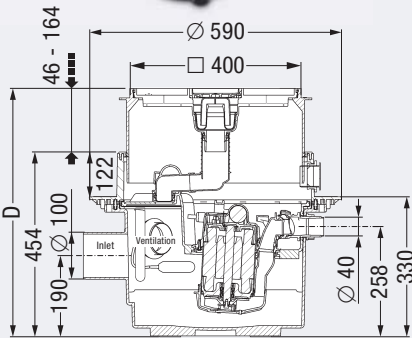

Wastewater lifting station *Aqualift® F Duo Underground* for wastewater with or without sewage for underground installation / in a concrete slab/floor

Installation depth (D) 500 mm to 618 mm
for covers with integrated odour traps
(sealing water height 50 mm)

Installation depth (D) 481 mm to 618 mm
for covers with Multistop as odour trap

With side inlet \varnothing 110, integrated outlet pipe, odour trap.
With telescopic extension section for continuous height
and level adjustment, recessed cover made of polymer,
Class A 15, with moisture protective sealing flange,
with twin removable pumps, with integrated macerator
and pneumatic control, **with integrated backwater
flap**. Ventilation connection \varnothing 75

Pressure connection: 1½ inch outer thread or
Pressure pipe \varnothing 40 mm for PVC glued connection
or pressure pipe set.

Installation area 800 x 800 mm

CE Certification no. Z-53.2-484

Twin station with SDS control unit (Self diagnosis system) for fully automated pump control, splash-proof (IP 54) twin removable pumps

\varnothing 40 28330

Pumping height: max. 8 m.
Voltage: 230 V ~ 50 Hz.
Power cable: 5 m.
Intake power: 2 x 1.0 kW
Weight: approx. 30 kg

Optional:
potential-free contact (Art. # 80 072),
Audible alarm (Art. # 20 162)

Accessories

Performance Diagram Wastewater Station *Aqualift® F*

Max. pumping capacity Q (m³/h)	0.0	3.0	5.0	6.5	7.8	9.0	10.0
Max. pumping capacity (l/s)	0.0	0.8	1.4	1.8	2.2	2.5	2.8
Pumping height H (mWS)	8.0	7.5	6.8	6.0	5.0	4.0	2.8

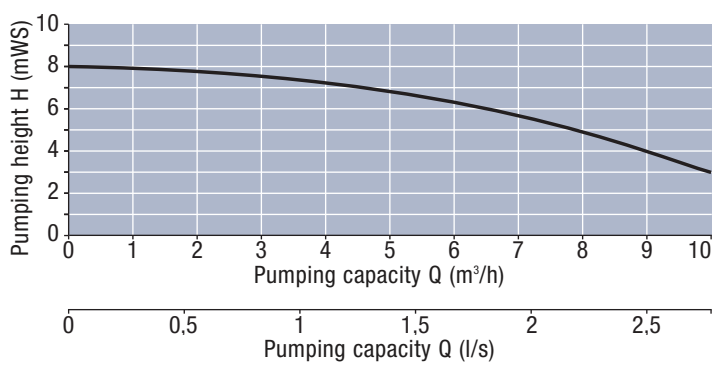

Current type	Vol-tage	Cur-rent	Motor rating P ₁ / P ₂
Alternating current	230 V	4.9 A	1000 W / 550 W
RPM	Motor protection	Operating type	
2800 min ⁻¹	thermal in the motor	S3 - 30%	

Twin station ≙ S1 Mono station



KESSEL - typical advantages

- Integrated drain function to drainage surface water** Continual drainage even in the event of a catastrophe
- Suitable for installation in a concrete slab/floor.** The telescopic extension section allows flexible adjustments to suit the required installation depth.
- Elegant optical appearance** even for cellar rooms which are used as living accommodation.

Accessories

	Ø	Art. #
 <p>Cover plate with drain</p> <ul style="list-style-type: none"> <input type="checkbox"/> recessed for on-site tiling, grey, for tile thicknesses of 18 mm, Class A 15 <input type="checkbox"/> with integrated grating, black, Class A 15 	-	83 045
	-	83 046
	-	43 500
 <p>Multistop as an odour, foam, rodent and insect stop for Art. # 83 045 and 83 046</p>	-	43 700
 <p>Hair filter made of polymer for Art. # 83 045 and 83 046</p>	-	83 023
 <p>Gasket set consisting of: Counter flange made of polymer, incl. screws Elastomer waterproof membrane in NK/SBR Ø 800 mm</p>	-	83 071
 <p>Extension section with flange made of polymer H = 180 mm, including gasket Integrated floor drain outlet extendable on-site with HT pipe Ø 50. For gasket set Art. # 83 023</p>	-	83 070
 <p>Extension section made of polymer, H = 180 mm, incl. gasket</p>	-	20 221
 <p>Alarm with optical probe for Art. # 28 300</p>	Ø 40	28 040
 <p>Pressure pipe set Incl. 5 m pressure pipe hose Ø 40, Adaptor with pipe clamp</p>	-	80 072
 <p>Potential-free contact Relay max 42 V / 0.5 A for Art. # 28 350, 28 330</p>	-	20 162
 <p>Audible alarm Voltage range 6 - 24 V DC for Art. # 28 350, 28 330</p>	-	

Lifting station *Aqualift® F* for wastewater with or without sewage with/without closure valve for above ground installation according to EN 12056

Illustration and dimensioned drawing

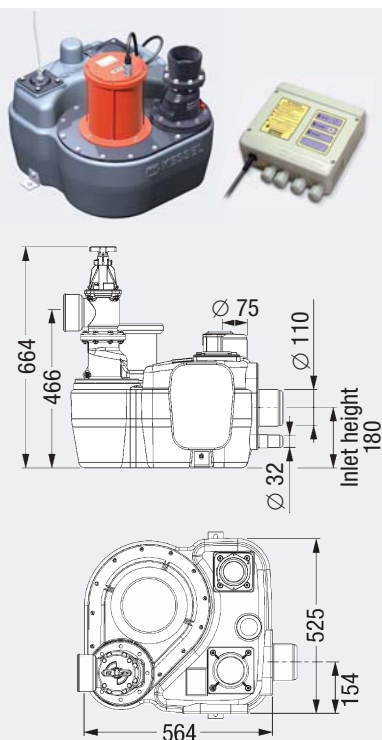

Article description

Lifting station *Aqualift® F* Single station

for wastewater with or without sewage
for free installation in frost-free rooms

Consisting of:

Polyethylene storage chamber, chamber volume approx. 50 liters, pumping volume approx. 20 liters, with air pressure level detector, clean-out opening. Connection for inlet \varnothing 110 (inlet height 180 mm) and ventilation \varnothing 75, connection coupling for manual diaphragm pump \varnothing 32.

Wastewater pump with non-chokable impeller to pump wastewater with or without sewage (open channel passage 40 mm). Pump is rated submersible (IP 68), power cable length 5 m.

Vertical / horizontal outlet with integrated non-return valve, connection coupling \varnothing 110 with hose section, **with/without closure valve** (provided loose)

Electric control unit for fully automated pump operation, control unit is splash proof (IP 65 at 400 V, IP 54 at 230 V), wall mounted, voltage 400 V DS or 230 V WS at 50 Hz. With potential-free contact.

Total weight approx. 44 kg.



Power

Current connection

Art.

Without closure valve
with vertical pressure outlet:

1.1 kW	400 V	28 645
1.1 kW	230 V	28 646
2.2 kW	400 V	28 647

With closure valve
with horizontal pressure outlet:

1.1 kW	400 V	28 644
1.1 kW	230 V	28 648
2.2 kW	400 V	28 649



Lifting station *Aqualift® F Duo* for wastewater with or without sewage with or without closure valve for above ground installation according to EN 12056

Illustration and dimensioned drawing

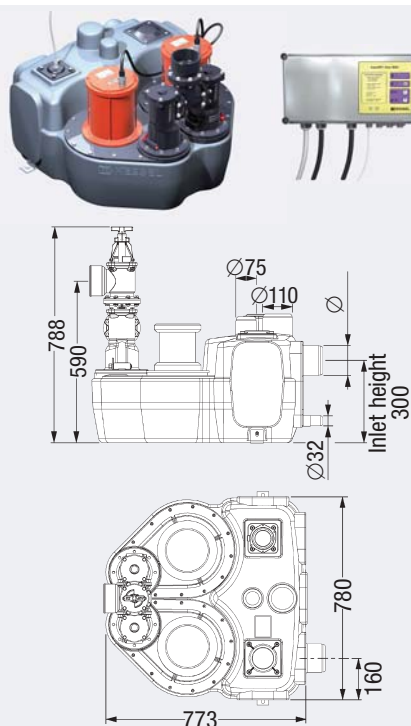

Article description

Lifting station *Aqualift® F Duo* Twin station

for wastewater with or without sewage
for free installation in frost-free rooms

Consisting of:

Polyethylene storage chamber, chamber volume approx. 120 liters, pumping volume approx. 50 liters, with air pressure level detector, clean-out opening. Connection for inlet \varnothing 110 (inlet height 300 mm) and ventilation \varnothing 75, connection coupling for manual diaphragm pump \varnothing 32.

Twin wastewater pump with non-chokable impeller to pump wastewater with or without sewage (open channel passage 40 mm). Pump is rated submersible (IP 68), power cable length 5 m.

Vertical/horizontal outlet with integrated non-return valve, connection coupling \varnothing 110 with hose section, **with/without closure valve** (provided loose)

Electric control unit for fully automated pump operation, control unit is splash proof (IP 65), wall mounted, voltage 400 V DS at 50 Hz. With potential-free contact.

Total weight approx. 84 kg.



Power

Current connection

Art.

Without closure valve
with vertical pressure outlet:

1.1 kW	400 V	28 652
2.2 kW	400 V	28 634

With closure valve
with horizontal pressure outlet:

1.1 kW	400 V	28 659
2.2 kW	400 V	28 631

Lifting station **Aqualift® F** for wastewater with or without sewage with/without closure valve for above ground installation according to EN 12056

Performance Diagram **Aqualift® F**

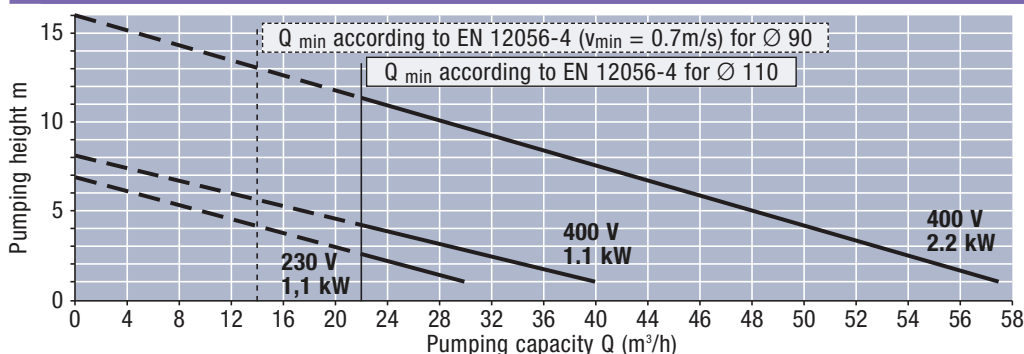

Type	400 V - 1.1 kW	400 V - 2.2 kW	230 V - 1.1 kW
Power (P2)	1.1 kW	2.2 kW	1.1 kW
Intake Power (P1)	1.4 kW	2.7 kW	1.7 kW
Voltage	400 V DS	400 V DS	230 V WS
Cycles	50 Hz	50 Hz	50 Hz
Amperage	2.7 A	4.9 A	7.3 A
Fuses	3 x 16 A surge-proof	3 x 16 A surge-proof	16 A surge-proof
Cable connections	5 m Length, 7 x 1.5 mm ²	5 m Length, 7 x 1.5 mm ²	5 m Length, 7 x 1.5 mm ²
Media temperature	35°C	35°C	35°C
Weight (Pump)	30 kg	31 kg	30 kg
Protection	IP 68	IP 68	IP 68
Operating mode	S1 max. running duration 240 min.	S3 30% power on duration	S3 60% power on duration
U / min	1.410	2.850	1.290

KESSEL - typical advantages

Quality and reliability are our strengths:

- Reliable function and fully automated operation
- High capacity and compact pumps
- Simple to install or mount in a small space
- Komfort control unit (optional)** alerts via GSM-interface, four-line display of operating status



+ Accessories

		Ø	Art. #
 Art. # 28 683	Closure valve for Art. # 28 645, 28 646, 28 647, 28 652, 28 634 as retrofit kit	Ø 110	28 683
		Ø 110	28 698
		Ø 160	28 699
 Art. # 28 698	Closure valve made of polymer for installation on inlet side (no pressure)		
	Manual diaphragm pump 1½ inch for manually pumping the wastewater. With a ball valve on inlet and outlet side	1½ inch	28 680
	Elastic hose connection Rubber fabric hose (L = 200 mm) with two hose clamps for connecting pipe lines	Ø 32	28 660
		Ø 75	28 661
		Ø 110	28 663
	Sound absorption sound-absorbing underlay mat (10 mm thick)		
		-	28 692
		-	28 693
	Pipe sealing gasket (EPDM) Use KESSEL hole saw when drilling.	Ø 50	850 114
		Ø 75	850 116
		Ø 110	850 117
		Ø 125	850 118
		Ø 160	850 119
	Hole saw for drilling lateral surfaces for inlets and outlets Ø 50, 75, 110, 125 and 160 (Saw blade holder Ø = 190 mm)	-	50 100

Wastewater lifting station *Aqualift® S* for sewage free wastewater

For interior installation according to EN 12056

Illustration and dimensioned drawing

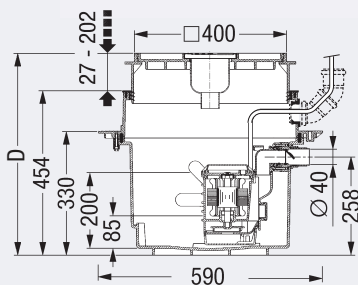

Installation area 700 x 700 mm

Article description

Wastewater lifting station *Aqualift® S* made of polymer for underground installation

For installation in a concrete slab/floor,
Installation depth (D) 481 mm to 656 mm.

With telescopic extension section for continuous
height and level adjustment, recessed cover
made of polymer, Class A 15,
with moisture protective sealing flange,
with removable pump and float control,
integrated backwater flap.

Pressure connection: 1½ inch outer thread,
Pressure pipe Ø 40 mm for PVC glued connection
or pressure pipe set.

max. pumping height: 8 m
Voltage: 230 V ~ 50 Hz
Intake power: 0.5 kW
Pump on level: 200 mm
Pump off level: 85 mm
Max. particle size: 10 mm
Power cable: 5 m
Weight: ca. 19 kg



CE EN 12050-2

Ø

Art. #

Ø 40

28 500

Optional:

Multistop as an odour, foam,
rodent and insect stop, page 43
Hair filter page 43

Wastewater lifting station *Aqualift® S Tronic / Aqualift® S Duo* for sewage free wastewater

For interior installation according to EN 12056

Illustration and dimensioned drawing

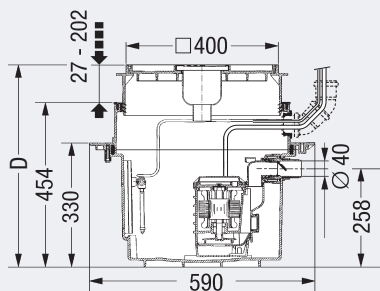

Installation area 700 x 700 mm

Article description

Wastewater lifting station *Aqualift® S Tronic / Aqualift® S Duo* made of polymer for underground installation

For installation in a concrete slab/floor,
Installation depth (D) 481 mm to 656 mm.

With telescopic extension section for continuous
height and level adjustment, recessed cover
made of polymer, Class A 15,
with moisture protective sealing flange,
integrated backwater flap.

Pressure connection: 1½ inch outer thread,
Pressure pipe Ø 40 mm for PVC glued connection
or pressure pipe set.
Max. particle size: 10 mm. max. pumping height: 8 m.
Voltage: 230 V ~ 50 Hz.

Aqualift® S Tronic with removable pump and probe control for conductive fluids, with control unit,

Intake power: 0.5 kW.
Power cable: 5 m. Weight: approx. 19 kg.

Aqualift® S Duo with two removable pumps and probe control for conductive fluids, with control unit, Intake power: 2 x 0.5 kW.

Power cable: 5 m. Weight: approx. 26 kg.
With potential-free contact.

Probe control not to be used for stormwater.
Special solutions available on request.



CE EN 12050-2

Ø

Art. #

Ø 40

28 550

Ø 40

28 530

Optional:

Audible alarm page 43
Potential-free contact page 43
Multistop as an odour, foam,
rodent and insect stop, page 43
Hair filter page 43



Wastewater lifting station **Aqualift® S** for sewage free wastewater For interior installation according to EN 12056

Performance diagram **Aqualift® S-Pump**

Max. pumping capacity Q (m³/h)	0.0	1.1	2.2	3.3	4.3	5.2	6.1	6.9	7.7	8.5
Max. pumping capacity (l/s)	0.0	0.3	0.6	0.9	1.2	1.4	1.7	1.9	2.1	2.4
Pumping height H (mWS)	8.0	7.0	6.5	5.5	4.5	3.5	3.0	2.0	1.5	0.0

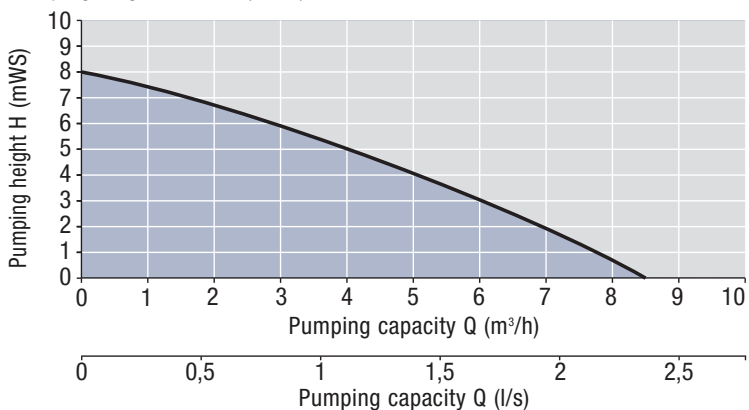

Current type	Voltage	Current	Motor rating P ₁ / P ₂	RPM	Motor protection	Plug
Alternating current	230 V	2.12 A	480 W / 320 W	2800 min ⁻¹	integrated	Schuko 5 m cable

Deep installation

**D max. = 800 mm
from 661 - 836 mm**

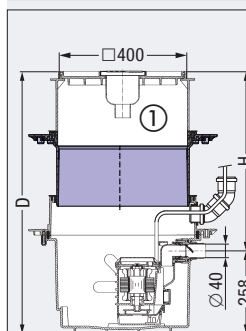

**Extension section
Art. # 83071**

H = 468 - 638 mm

① Odour trap can be retrofitted

KESSEL - typical advantages

Three functions...

- ① **Lifting station** for wastewater without sewage
- ② **Discharge**, even with a fractured pipe or incoming flood water
- ③ **Chamber ready to be installed**, can even be installed in waterproof concrete

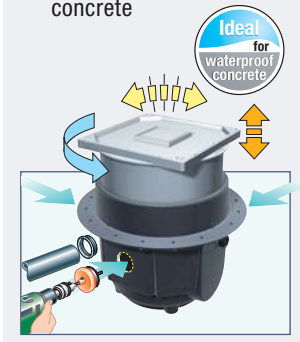

+ Accessories

		Ø	Art. #
	Pressure pipe set Incl. 5 m pressure pipe hose Ø 40, Adaptor with pipe clamp	Ø 40	28 040
	Alarm Type 20220 / 20221 <input type="checkbox"/> with electrode probe for Art. # 28 500 <input type="checkbox"/> with optical probe for Art. # 28 500	-	20 220 20 221
	Cover plate made of polymer surface rain water tight, black, Class A 15. Ventilation pipe necessary, incl. gasket 173-145 surface rain water tight, recessed for on-site tiling, grey, for tile thicknesses of 18 mm, Class A 15 with integrated grating, black, Class A 15	-	83 050 83 052 83 053
	Gasket set consisting of: Counter flange made of polymer, incl. screws Elastomer waterproof membrane in NK/SBR Ø 800 mm	-	83 023
	Extension section with flange made of polymer H = 180 mm, including gasket Integrated floor drain outlet extendable on-site with HT pipe Ø 50. For gasket set Art. # 83 023	-	83 071
	Extension section made of polymer, H = 180 mm, incl. gasket	-	83 070
	Pipe sealing gasket (EPDM)	Ø 50 Ø 75 Ø 110	850 114 850 116 850 117
	Hole saw Ø 50, 75, 110 for drilling	-	50 101
	Odour trap made of polymer 50 mm seal water height It is also necessary to use a ventilation pipe	-	47 200

Twin lifting station for wastewater without sewage / wastewater lifting station *Minilift*

For interior installation according to EN 12056

Wastewater lifting stations for interior installation

Lifting stations for interior installation

Lifting stations for exterior installation

Submersible pumps

Illustration and dimensioned drawing

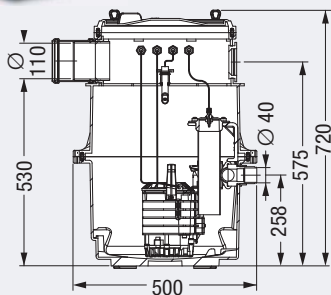

Article description

Twin pump lifting station
made of polymer for above ground installation
With twin removable pumps,
 integrated backwater flap,
Pressure diaphragm control.
 Inlet \varnothing 110, ventilation connection \varnothing 75
 (incl. pipe sealing gasket),
 With potential-free contact.
 Pressure connection: 1 1/2 inch outer thread or
 pressure pipe \varnothing 40 mm for PVC glued connection.
 Inlet height: 530 mm
 Total height: 720 mm, \varnothing 450 mm
 Voltage: 230 V ~ 50 Hz
 Max. chamber size: 55 l
 max. pumping height: 8 m
 Intake power: 2 x 0.5 kW
 Power cable: 5 m
 Weight: ca. 25 kg

Certification: Z-53.3-310
EN 12050-2

Pressure connection Art.

\varnothing 40 28541



Optional:
 Audible alarm page 49

Performance diagram
 page 47

Illustration and dimensioned drawing

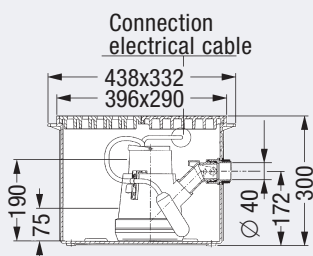

Installation area 500 x 400 mm

Wastewater lifting station *Minilift*

made of polymer for underground installation

With removable pump and backwater flap and grating
 and cover plate class L15. Certified for wastewater.
 Pressure connection: 1 1/2 inch outer thread,
 Pressure pipe \varnothing 40 mm for PVC glued connection
 or pressure pipe set.
 Pumping height: 6.2 m
 Voltage: 230 V ~ 50 Hz
 Intake power: 0.3 kW
 Power cable: 5 m
 Max. particle size: 10 mm
 Pump on level: 190 mm
 Pump off level: 75 mm

EN 12050-2

Pressure connection Art.

\varnothing 40 28570

Performance diagram
 page 49

Illustration and dimensioned drawing

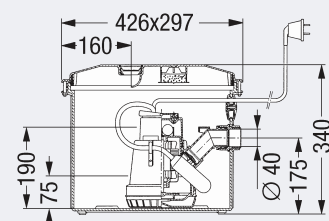

Wastewater lifting station *Minilift*

made of polymer for above ground installation

With removable pump and backwater flap.
 Certified for wastewater.
 Pressure connection: 1 1/2 inch outer thread or
 pressure pipe \varnothing 40 mm for PVC glued connection
 Pumping height: 6.2 m
 Voltage: 230 V ~ 50 Hz
 Intake power: 0.3 kW
 Pump on level: 190 mm
 Pump off level: 75 mm
 Max. particle size: 10 mm
 Power cable: 5 m

EN 12050-2

Pressure connection Art.

\varnothing 40 28560

Performance diagram
 page 49

Wastewater lifting station *Minilift*

For above ground installation

Performance diagram *Minilift*

The KESSEL *Minilift* lifting station fits easily underneath any wash-basin; it can also be connected to a washing machine, shower or other inlets.

The station is equipped with a 300 W wastewater pump with a float control. The „single hand snap closure“ means that special tools are not required to remove the pump for cleaning. The pressure pipe can be a PVC pipe \varnothing 40 mm. It is also possible using a screw connection 1½ inch to connect the pressure pipe to the lifting station.

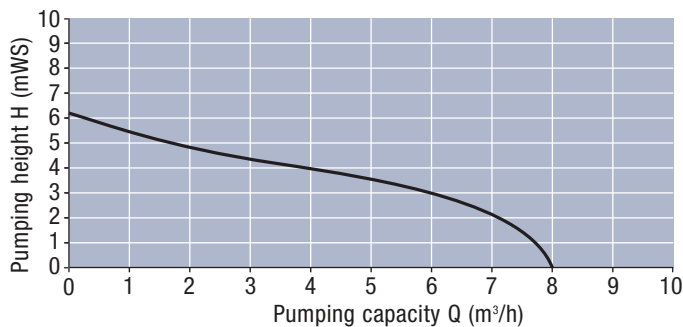

Installation example

Wastewater lifting station *Minilift* - Above ground option can also be retro-fitted











Wastewater lifting stations for interior installation

Lifting stations for interior installation

Lifting stations for exterior installation

Submersible pumps

+ Accessories

		\varnothing	Art. #
	Pressure pipe set incl. 5 m pressure pipe hose \varnothing 40, Adaptor with pipe clamp for Art. # 28570	\varnothing 40	28040
	Extension section made of polymer Height = 220 mm for deep installation for Art. # 28570	-	32500
	Cover plate Class L 15 <input type="checkbox"/> grey <input type="checkbox"/> black	-	30 003W 30 003S
	Cover with grating Class L 15 <input type="checkbox"/> grey <input type="checkbox"/> black	-	30 001W 30 001S
	Pipe sealing gasket (EPDM) Use KESSEL hole saw when drilling. for Art. # 28541, 28570, 28560	\varnothing 50 \varnothing 75 \varnothing 110	850 114 850 116 850 117
	Hole saw for drilling lateral surfaces for inlets and outlets \varnothing 50, 75, 110 (Saw blade holder \varnothing = 145 mm)	-	50 101
	Potential-free contact Relay max 42 V / 0.5 A for Art. # 28541	-	80072
	Audible alarm Voltage range 6 - 24 V DC for Art. # 28541	-	20162

Lifting station *Aqualift® F Duo XXL* for wastewater with or without sewage

For free installation in frost free areas

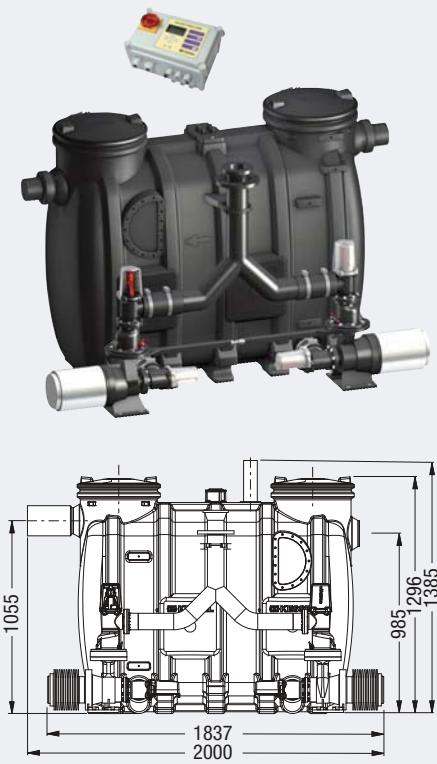
Illustration and dimensioned drawing	Article description	Power	Current connection	Art. #
	<p>Lifting station <i>Aqualift® F Duo XXL</i> twin lifting station with closure valve for wastewater with or without sewage (For use with grease separators size NS 10 and larger) for free standing installation in frost free areas</p> <p>Consists of:</p> <p>Polyethylene collection chambers, storage volume 750 liter, pumping volume 300 liter, pneumatic level control, twin 420 mm OD access / maintenance covers, Ø 160 inlet (Ø 200 available upon request), inlet height 1055 mm, ventilation connection size Ø 110.</p> <p>Twin wastewater pumps with macerating (cutting assembly) for pumping wastewater with or without raw sewage, IP 68 submersible pumps, Duty / Standby operation, 5 meter power cable length.</p> <p>Vertical pressure outlet with Ø 110 connection and flange, with closure valve and integrated backflow preventer.</p> <p>Electrical control for fully automated pump control, IP 54 splash proof control unit housing, for wall mounting, operational voltage - 400 V DS, with potential free contact (BMS) connections). Total weight empty: approx 220 kg</p> <p>CE EN 12050-1</p>	2.6 kW	400 V	28638
		3.5 kW	400 V	28639
		4.8 kW	400 V	28640

Performance Diagram *Aqualift® F Duo XXL*

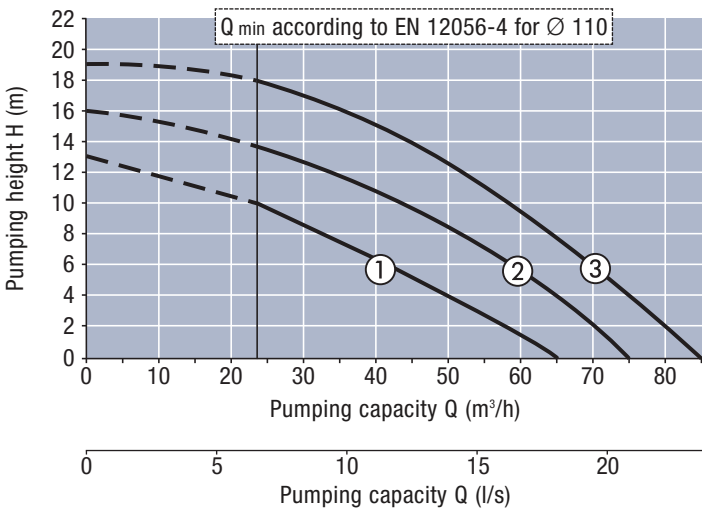

Type	SPF260KE	SPF400KE	SPF550KE
Power (P2)	2.6 kW	3.5 kW	4.8 kW
Intake Power (P1)	3.3 kW	4.2 kW	5.6 kW
Voltage	400 V DS	400 V DS	400 V DS
Cycles	50 Hz	50 Hz	50 Hz
Amperage	5.6 A	8.2 A	10.2 A
Cable connections	5 m Length, 7 x 1.5 mm ²	5 m Length, 7 x 1.5 mm ²	5 m Length, 7 x 1.5 mm ²
Media temperature	40°C	40°C	40°C
Protection	IP 68	IP 68	IP 68

- ① SPF260KE
- ② SPF400KE
- ③ SPF550KE

Lifting stations for exterior installation

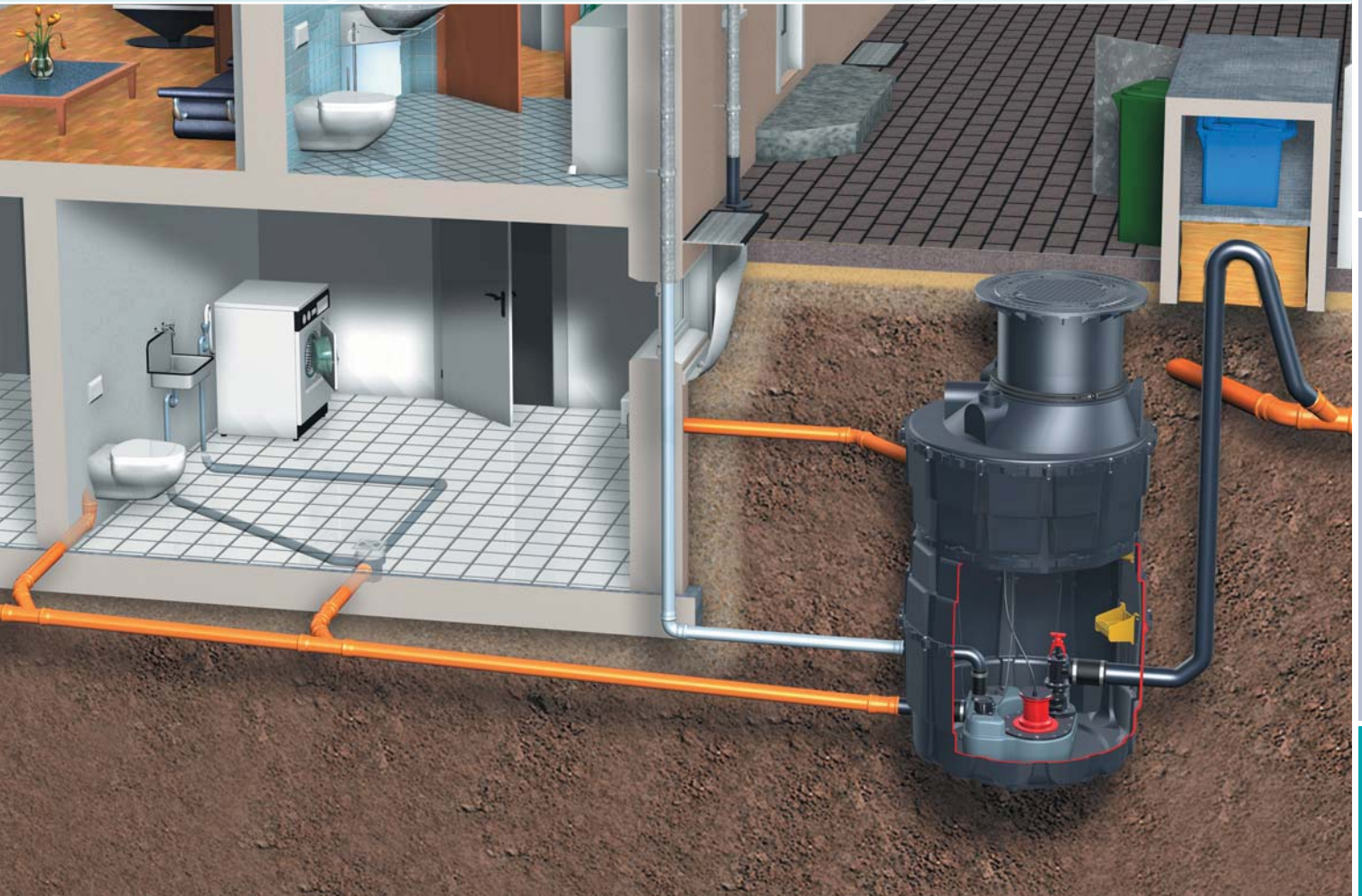

Ecolift® wastewater lifting system
for interior installation

Lifting stations
for interior installation

Lifting stations
for exterior installation

Submersible pumps

Lifting station *Aqualift® F* for wastewater with or without sewage in Komfort inspection chamber system Ø 1000 (single station/twin station) Exterior to buildings according to EN 752

Illustration and dimensioned drawing

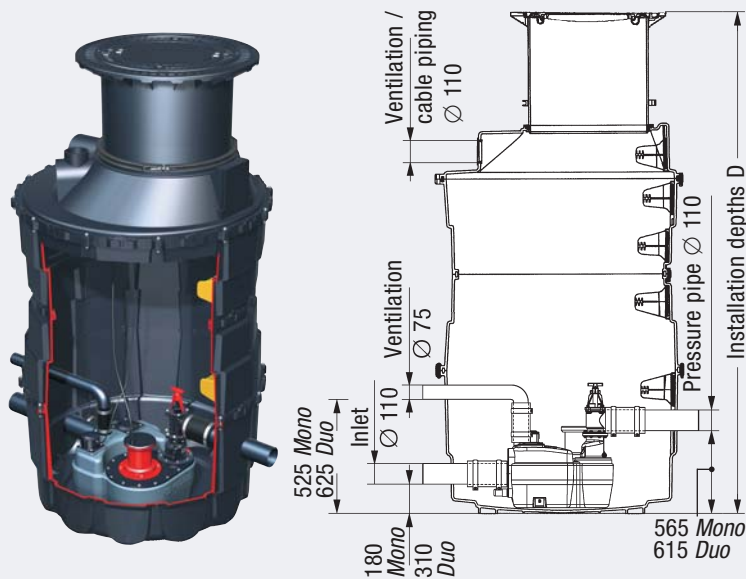
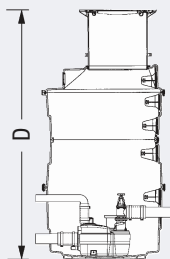

Illustration shows single station Art. # 866 621 B

We recommend that the inspection chamber is ventilated to prevent the formation of condensation water.

Installation depths (D):

D 1	1630 - 2130 mm
D 2	2130 - 2630 mm
D 3	2630 - 3130 mm
D 4	3130 - 3630 mm
D 5	3630 - 4130 mm
D 6	4130 - 4630 mm
D 7	4630 - 5130 mm



Article description

Lifting station *Aqualift® F* Single station/twin station

for wastewater with or without sewage with closure valve

For underground installation (dry installation)

Consisting of:

Lifting station with PE storage chamber,

Chamber volume *Mono* approx. 50 liters/
Duo approx. 120 liters

Pumping volume *Mono* approx. 20 liters/
Duo approx. 50 liters

with air pressure level detector, clean-out opening.

Connection coupling for inlet Ø 110

(Inlet height *Mono* 180 mm / *Duo* 310 mm)

and for ventilation Ø 75, *Mono* 525 mm / *Duo* 625 mm

Connection coupling for manual diaphragm pump Ø 32.

Wastewater pump with non-chokable impeller to pump wastewater with or without sewage (open channel passage 40 mm). Pump is rated submersible (IP 68), power cable length 10 m.

Horizontal pressure outlet with integrated backwater flap, connection coupling Ø 110 *Mono* 565 mm / *Duo* 615 mm hose section and closure valve.

Electric control unit or fully automated pump operation, control unit is splash proof (IP 65 at 400 V, IP 54 at 230 V), wall mounted, voltage 400 V DS or 230 V WS at 50 Hz. With potential-free contact.

Ready mounted in the

Inspection chamber system Ø 1000 in PE-HD, incl. access steps, water-tight, with continuous height and level adjustment, cover Class A/B, D in cast iron according to EN 124, inlet Ø 110, connection bore with gasket for cable piping Ø 110,

Installation depth from 1.5 to 5 m (see table),

Pressure pipe Ø 110 ready mounted with closure valve.

Handles groundwater depths up to 500 mm



Pumping capacity 1.1 kW

Pumping capacity 2.2 kW

Installation depth D in mm	Voltage	Art. #	
		Class A/B	Class D

Installation depth D in mm	Voltage	Art. #	
		Class A/B	Class D

Single station:

Single station:

D 1: 1630 - 2130 mm	400 V	866 611 B	866 611 D
D 2: 2130 - 2630 mm	400 V	866 621 B	866 621 D
D 3: 2630 - 3130 mm	400 V	866 631 B	866 631 D
D 4: 3130 - 3630 mm	400 V	866 641 B	866 641 D
D 5: 3630 - 4130 mm	400 V	866 651 B	866 651 D
D 1: 1630 - 2130 mm	230 V	867 611 B	867 611 D
D 2: 2130 - 2630 mm	230 V	867 621 B	867 621 D

D 1: 1630 - 2130 mm	400 V	866 711 B	866 711 D
D 2: 2130 - 2630 mm	400 V	866 721 B	866 721 D
D 3: 2630 - 3130 mm	400 V	866 731 B	866 731 D
D 4: 3130 - 3630 mm	400 V	866 741 B	866 741 D
D 5: 3630 - 4130 mm	400 V	866 751 B	866 751 D
D 6: 4130 - 4630 mm	400 V	866 761 B	866 761 D
D 7: 4630 - 5130 mm	400 V	866 771 B	866 771 D

Twin station:

Twin station:

D 1: 1630 - 2130 mm	400 V	868 611 B	868 611 D
D 2: 2130 - 2630 mm	400 V	868 621 B	868 621 D
D 3: 2630 - 3130 mm	400 V	868 631 B	868 631 D
D 4: 3130 - 3630 mm	400 V	868 641 B	868 641 D
D 5: 3630 - 4130 mm	400 V	868 651 B	868 651 D

D 1: 1630 - 2130 mm	400 V	868 711 B	868 711 D
D 2: 2130 - 2630 mm	400 V	868 721 B	868 721 D
D 3: 2630 - 3130 mm	400 V	868 731 B	868 731 D
D 4: 3130 - 3630 mm	400 V	868 741 B	868 741 D
D 5: 3630 - 4130 mm	400 V	868 751 B	868 751 D
D 6: 4130 - 4630 mm	400 V	868 761 B	868 761 D
D 7: 4630 - 5130 mm	400 V	868 771 B	868 771 D

Lifting station *Aqualift® F* for wastewater with or without sewage in Komfort inspection chamber system \varnothing 1000 (single station/twin station) Exterior to buildings according to EN 752

Installation suggestion

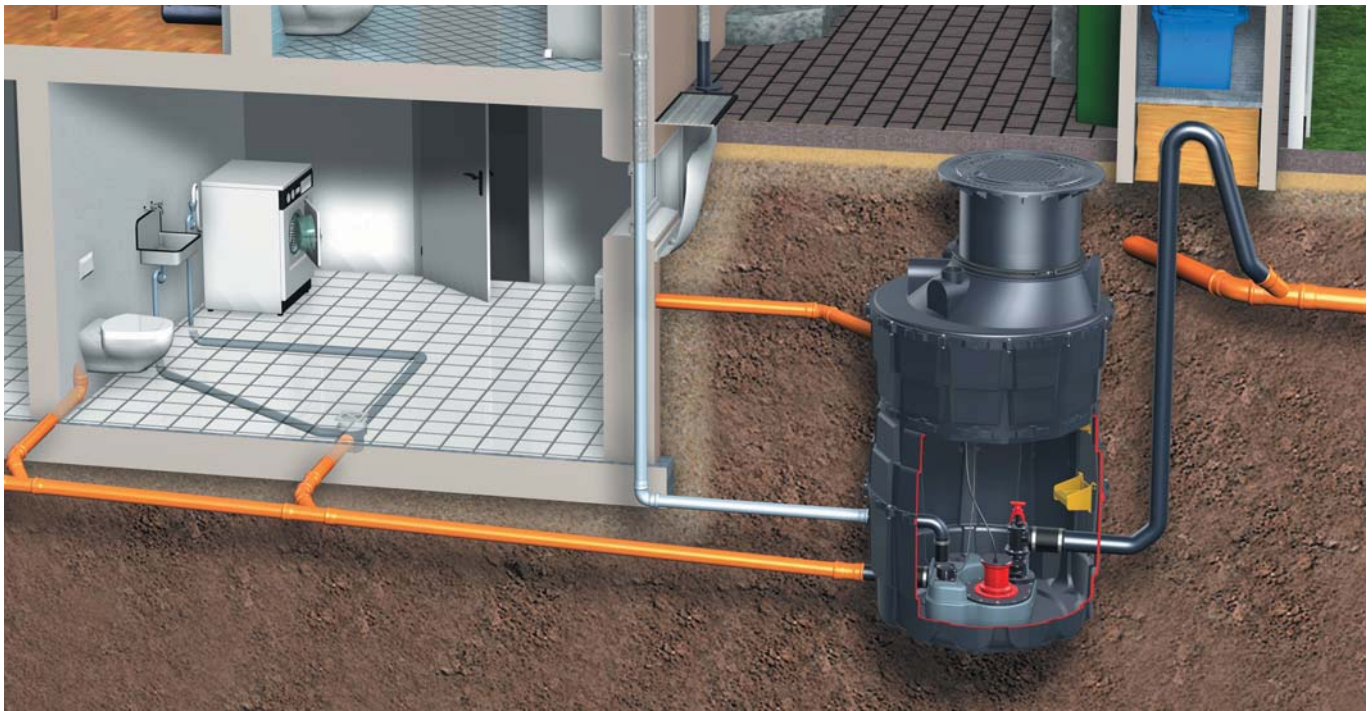

Performance diagram wastewater lifting installation *Aqualift® F*

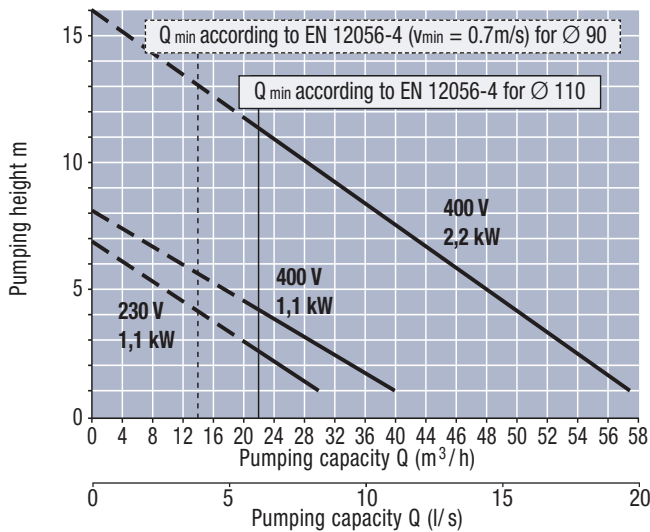

Type	400 V - 1.1 kW	400 V - 2.2 kW	230 V - 1.1 kW
Power (P2)	1.1 kW	2.2 kW	1.1 kW
Intake Power (P1)	1.4 kW	2.7 kW	1.7 kW
Voltage	400 V DS	400 V DS	230 V WS
Cycles	50 Hz	50 Hz	50 Hz
Amperage	2.7 A	4.9 A	7.3 A
Fuses	3x 16A surge-proof	3x 16A surge-proof	16 A surge-proof
Cable connections	10 m Length, 7 x 1.5 mm ²	10 m Length, 7 x 1.5 mm ²	10 m Length, 7 x 1.5 mm ²
Media temperature	35°C	35°C	35°C
Weight (Pump)	30 kg	31 kg	30 kg
Protection	IP 68	IP 68	IP 68
Operating mode	S1 max. running duration 240 min.	S3 30% power on duration	S3 60% power on duration

KESSEL - typical advantages

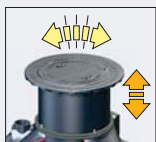

Variable extension section:

- inclinable
- height adjustable from 100 to 600 mm

- **Simple to assemble** with light-weight inspection chamber components and easy connection technique.
- **Quick to mount** with a high level of pre-fabrication (bottom part of inspection chamber with pressure pipe) and **easy connection** using fixed couplings for inlet and pressure pipe and bores with lip gaskets for ventilation and cable piping.
- **Long-term reliability** with an absolute water-tight inspection chamber system which is resistant to sedimentary deposits and aggressive media as well as root infiltration.
- **Fully automated operation** with an electrical switch with manual, off and automatic mode, optical and audible warning and alarm notification, detailed operation and warning display, integrated pump rotation check, anti-blocking function, variable pump on and pump off settings.

Pumping station *Aqualift® F* for wastewater with or without sewage in Komfort inspection chamber system Ø 1000 (single station/twin station) Exterior to buildings according to EN 752

Illustration and dimensioned drawing

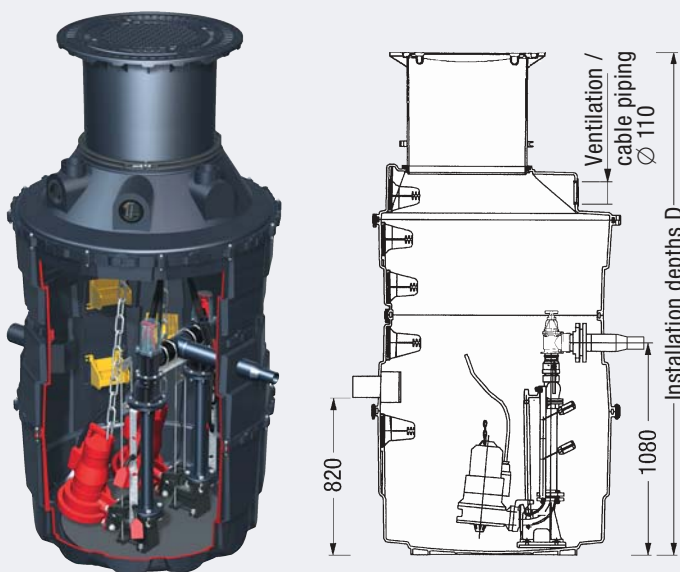
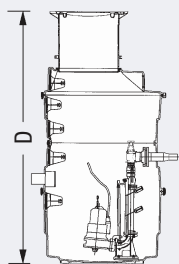

Illustration shows twin station Art. # 864 620 B

Installation depths (D):

D 1	1630 - 2130 mm
D 2	2130 - 2630 mm
D 3	2630 - 3130 mm
D 4	3130 - 3630 mm
D 5	3630 - 4130 mm
D 6	4130 - 4630 mm
D 7	4630 - 5130 mm



Article description

Pumping station *Aqualift® F* Single station/twin station

for wastewater with or without sewage

For underground installation

Consisting of:

Inspection chamber system Ø 1000 in PE-HD, including access steps, water-tight, resistant to aggressive media, extension section made of polymer, continuous height and level adjustment, cover Class A/B, D in cast iron according to EN 124, Inlet Ø 160, connection bore with gasket for Ø 110 according to EN 1401 (DIN 19534) and DIN 19537 for ventilation pipes and cable piping respectively, Installation depth from 1.5 to 5 m (see table), Pumping volume approx. 180 liters.

Pressure pipe ready mounted with backwater flap, closure valve. Single station with three float switches, twin station with four float switches for level control with cable length 10 m, pressure pipe connection PE-HD Ø 63 and Ø 90.

Submersible motor pump TPF 1.3 KE / TPF 1.9 KE explosion-proof, with macerating blades for pumping wastewater with or without sewage, submersible (IP 68), electrical cable length 10 m.

Electric control unit for fully automated pump operation, control unit is splash proof (IP 65), for wall mounting in dry, frost-free areas, PTB certification for installation in explosion risk areas, Voltage 400 V DS at 50 Hz.

With potential-free contact.

Handles groundwater depths up to 500 mm

CE EN 12050-1

Pumping capacity 1.3 kW

Installation depth D in mm	Pressure pipe *	Art. #	
		Class A/B	Class D

Single station:

D 1: 1630 - 2130 mm	Ø 63/90	865 610 B	865 610 D
D 2: 2130 - 2630 mm	Ø 63/90	865 620 B	865 620 D
D 3: 2630 - 3130 mm	Ø 63/90	865 630 B	865 630 D
D 4: 3130 - 3630 mm	Ø 63/90	865 640 B	865 640 D
D 5: 3630 - 4130 mm	Ø 63/90	865 650 B	865 650 D
D 6: 4130 - 4630 mm	Ø 63/90	865 660 B	865 660 D
D 7: 4630 - 5130 mm	Ø 63/90	865 670 B	865 670 D

*) Ø 90 by sawing off

Twin station:

D 1: 1630 - 2130 mm	Ø 63/90	864 610 B	864 610 D
D 2: 2130 - 2630 mm	Ø 63/90	864 620 B	864 620 D
D 3: 2630 - 3130 mm	Ø 63/90	864 630 B	864 630 D
D 4: 3130 - 3630 mm	Ø 63/90	864 640 B	864 640 D
D 5: 3630 - 4130 mm	Ø 63/90	864 650 B	864 650 D
D 6: 4130 - 4630 mm	Ø 63/90	864 660 B	864 660 D
D 7: 4630 - 5130 mm	Ø 63/90	864 670 B	864 670 D

*) Ø 90 by sawing off

Pumping capacity 1.9 kW

Installation depth D in mm	Pressure pipe *	Art. #	
		Class A/B	Class D

Single station:

D 1: 1630 - 2130 mm	Ø 63/90	865 710 B	865 710 D
D 2: 2130 - 2630 mm	Ø 63/90	865 720 B	865 720 D
D 3: 2630 - 3130 mm	Ø 63/90	865 730 B	865 730 D
D 4: 3130 - 3630 mm	Ø 63/90	865 740 B	865 740 D
D 5: 3630 - 4130 mm	Ø 63/90	865 750 B	865 750 D
D 6: 4130 - 4630 mm	Ø 63/90	865 760 B	865 760 D
D 7: 4630 - 5130 mm	Ø 63/90	865 770 B	865 770 D

*) Ø 90 by sawing off

Twin station:

D 1: 1630 - 2130 mm	Ø 63/90	864 710 B	864 710 D
D 2: 2130 - 2630 mm	Ø 63/90	864 720 B	864 720 D
D 3: 2630 - 3130 mm	Ø 63/90	864 730 B	864 730 D
D 4: 3130 - 3630 mm	Ø 63/90	864 740 B	864 740 D
D 5: 3630 - 4130 mm	Ø 63/90	864 750 B	864 750 D
D 6: 4130 - 4630 mm	Ø 63/90	864 760 B	864 760 D
D 7: 4630 - 5130 mm	Ø 63/90	864 770 B	864 770 D

*) Ø 90 by sawing off

Pumping station *Aqualift® F* for wastewater with or without sewage in Komfort inspection chamber system Ø 1000 (single station/twin station) Exterior to buildings according to EN 752

Installation in the Komfort inspection chamber system Ø 1000 exterior to buildings

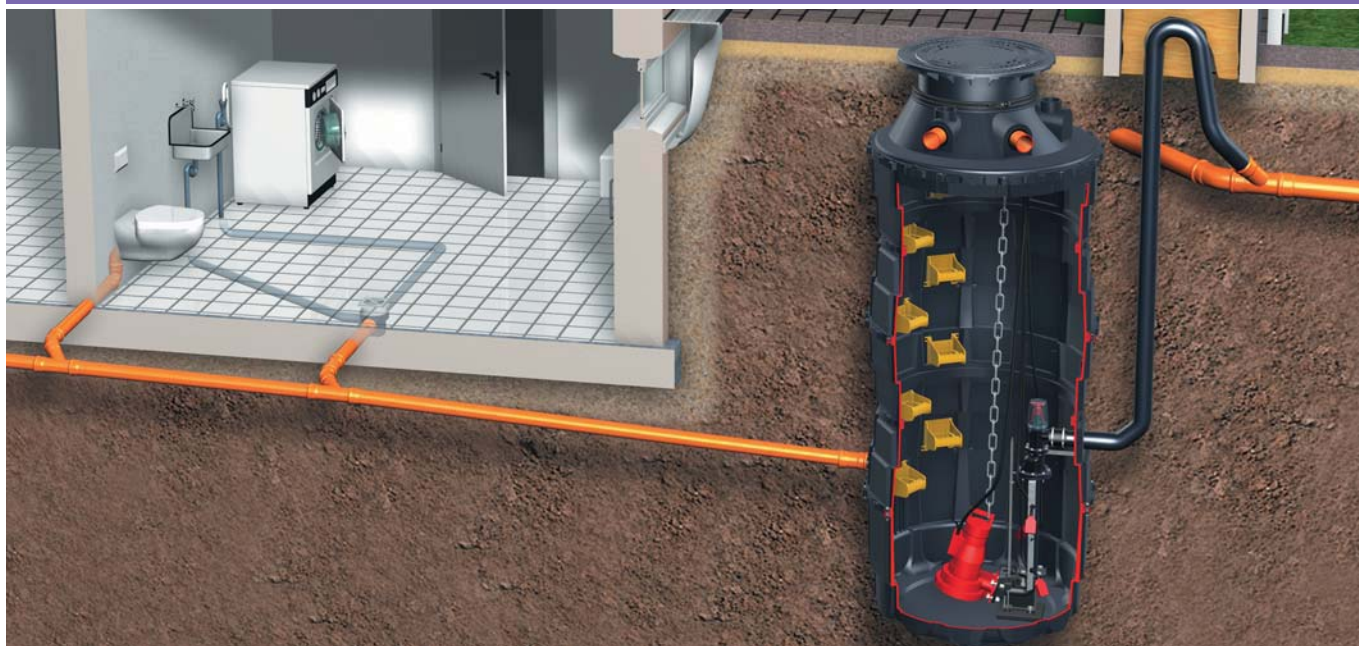

Performance diagram pumping station *Aqualift® F*

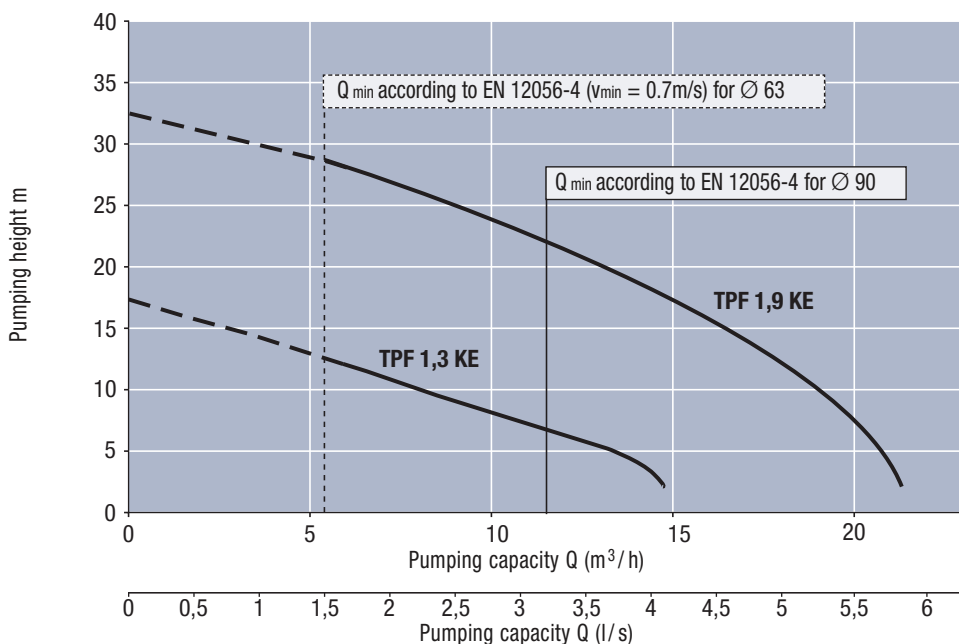

Pump type	TPF 1.3 KE
Power	1.3 kW
Intake power	1.75 kW
Amperage	3.5 A
Fuses	3 x 16 A surge-proof
Voltage	400 V DS at 50 HZ
Cable length	10 m Length, 7 x 1.5 mm ²
Protection	IP 68 Ex-protection

Pump type	TPF 1.9 KE
Power	1.9 kW
Intake power	2.6 kW
Amperage	4.5 A
Fuses	3 x 16 A surge-proof
Voltage	400 V DS at 50 HZ
Cable length	10 m Length, 7 x 1.5 mm ²
Protection	IP 68 Ex-protection

KESSEL - typical advantages

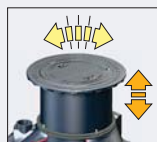

Variable extension section:

- inclinable
- height adjustable from 100 to 600 mm

- **Simple to assemble** with light-weight inspection chamber components and easy connection technique.
- **Quick to mount** with a high level of pre-fabrication (bottom part of inspection chamber with pressure pipe) **and easy connection** using fixed couplings for inlet and pressure pipe and bores with lip gaskets for ventilation and cable piping.
- **Long-term reliability** with an absolute water-tight inspection chamber system which is resistant to sedimentary deposits and aggressive media as well as root infiltration.
- **Fully automated operation** with an electrical switch with manual, off and automatic mode, optical and audible warning and alarm notification, detailed operation and warning display, integrated pump rotation check, anti-blocking function, variable pump on and pump off settings.

Pumping station *Aqualift*® S for wastewater without sewage / rainwater in inspection chamber system Ø 600 (single station/twin station)
Exterior to buildings according to EN 752

Illustration and dimensioned drawing

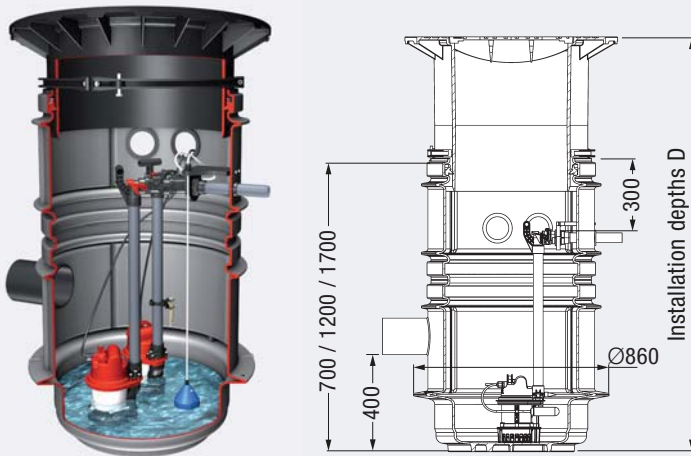

Illustration shows twin station Art. # 824 821 B

Installation depths (D):

D 1	800 - 1250 mm
D 2	1300 - 1750 mm
D 3	1800 - 2250 mm

Article description

Pumping station *Aqualift*® S Ø 600 Single station/twin station

for wastewater without sewage / rainwater

For underground installation, installation depth D

Consisting of:

Inspection chamber system Ø 600 in PE-LLD, resistant to aggressive media, extension section made of polymer, vertically adjustable upper section, cover Class A/B, D in cast iron according to EN 124. **Groundwater resistant.** Inlet Ø 110/160, connection for pipe seal for Ø 110 according to EN 1401 (DIN 19534) and DIN 19537 – each for ventilation or cable pipe,

Note: Consider frost free depth of pressure pipe
Pressure pipe Ø 40 mm outside diameter for PVC glue connection, with integrated non-return flap, 10 mm max solid size, Current: 230 V ~ 50 Hz. Power cable length: 10 m.

KTP 500/1000 float switch controlled removable pump for conductive or non-conductive fluids.

Start up power: 0.5 /1.0 kW.

KTP 500/1000 Tronic with removable pump and control unit – sensors operate in conductive and non-conductive fluids.

Start up power: 0.5 /1.0 kW.

KTP 500/1000 Duo with removable twin pump and control unit – sensors operate in conductive and non-conductive fluids.

Start up power: 2 x 0.5 /1.0 kW.

CE EN 12050-2

KTP 500		1 pump with float switch		1 pump with SDS-Control Unit		2 pumps with SDS-Control Unit	
Installation depth D in mm	Art. # Class A/B	Art. # Class D	Art. # Class A/B	Art. # Class D	Art. # Class A/B	Art. # Class D	
D 1	800 - 1250	825 810 B	825 810 D	825 811 B	825 811 D	824 811 B	824 811 D
D 2	1300 - 1750	825 820 B	825 820 D	825 821 B	825 821 D	824 821 B	824 821 D
D 3	1800 - 2250	825 830 B	825 830 D	825 831 B	825 831 D	824 831 B	824 831 D

KTP 1000		1 pump with float switch		1 pump with SDS-Control Unit		2 pumps with SDS-Control Unit	
Installation depth D in mm	Art. # Class A/B	Art. # Class D	Art. # Class A/B	Art. # Class D	Art. # Class A/B	Art. # Class D	
D 1	800 - 1250	827 810 B	827 810 D	827 811 B	827 811 D	826 811 B	826 811 D
D 2	1300 - 1750	827 820 B	827 820 D	827 821 B	827 821 D	826 821 B	826 821 D
D 3	1800 - 2250	827 830 B	827 830 D	827 831 B	827 831 D	826 831 B	826 831 D

Performance diagram pumping station *Aqualift*® S

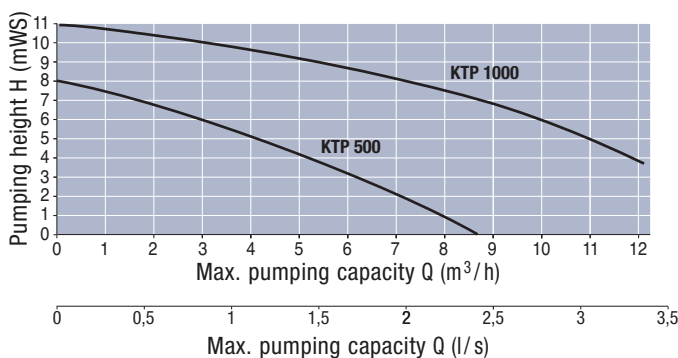

	KTP 500	KTP 1000
Current type	Alternating current	Alternating current
Voltage	230 V	230 V
Current	2.12 A	4.9 A
Motor rating P1/P2	480 W / 320 W	1000 W / 550 W
RPM	2800 min ⁻¹	2800 min ⁻¹
Motor protection	integrated	integrated
Operating mode	S1	S3 - 30%

Pumping station *Aqualift*® S for wastewater without sewage / rainwater in Komfort inspection chamber system Ø 1000 (single station/twin station)
Exterior to buildings according to EN 752

Illustration and dimensioned drawing

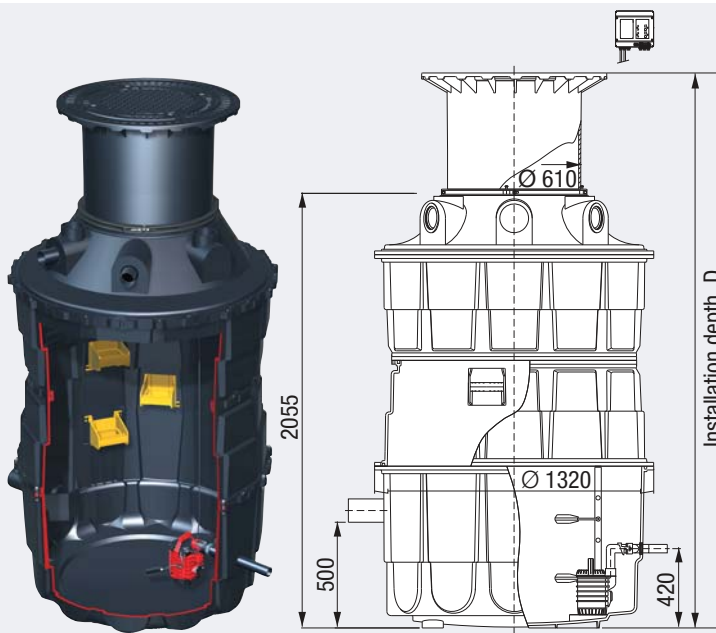

Illustration shows single station Art. # 865 821 B

Article description

Pumping station *Aqualift*® S Ø 1000 Single station/twin station

for sewage free wastewater / rainwater

For underground installation
Installation depth D

Consisting of:

Inspection chamber system Ø 1000 in PE-HD, including access steps, water-tight, resistant to aggressive media, extension section made of polymer, continuous height and level adjustment, cover Class A/B, D in cast iron according to EN 124.

Inlet Ø 110, connection drilling with gasket for Ø 110 according to EN 1401 (DIN 19534) and DIN 19537 for ventilation pipes and cable piping respectively, Installation depth from 1.5 to 5 m (see table), Pumping volume approx. 180 liters.

Pressure pipe outlet connection: 1½ inch exterior thread, Pressure pipe Ø 40 mm outside diameter for PVC glue connection, with integrated non-return flap, 10 mm max solid size.

Current: 230 V ~ 50 Hz.

Power cable length: 10 m.

KTP 500/1000 float switch controlled removable pump for conductive or non-conductive fluids.

Start up power: 0.5 /1.0 kW.

KTP 500/1000 Tronic with removable pump and control unit – sensors operate in conductive and non-conductive fluids.

Start up power: 0.5 /1.0 kW.

KTP 500/1000 Duo with removable twin pump and control unit – sensors operate in conductive and non-conductive fluids.

Start up power: 2 x 0.5 /1.0 kW.

With potential free contact.

Handles groundwater depths up to 500 mm

CE EN 12050-2

Installation depths (D):	
D 1	1630 - 2130 mm
D 2	2130 - 2630 mm
D 3	2630 - 3130 mm
D 4	3130 - 3630 mm
D 5	3630 - 4130 mm
D 6	4130 - 4630 mm
D 7	4630 - 5130 mm

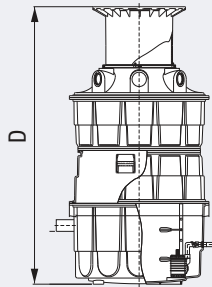

KTP 500		1 pump with float switch		1 pump with SDS-Control Unit		2 pumps with SDS-Control Unit	
Installation depth D in mm	Art. #	Art. #		Art. #		Art. #	
		Class A/B	Class D	Class A/B	Class D	Class A/B	Class D
D 1	1630 - 2130	865 810 B	865 810 D	865 811 B	865 811 D	864 811 B	864 811 D
D 2	2130 - 2630	865 820 B	865 820 D	865 821 B	865 821 D	864 821 B	864 821 D
D 3	2630 - 3130	865 830 B	865 830 D	865 831 B	865 831 D	864 831 B	864 831 D
D 4	3130 - 3630	865 840 B	865 840 D	865 841 B	865 841 D	864 841 B	864 841 D
D 5	3630 - 4130	865 850 B	865 850 D	865 851 B	865 851 D	864 851 B	864 851 D
D 6	4130 - 4630	865 860 B	865 860 D	865 861 B	865 861 D	864 861 B	864 861 D
D 7	4630 - 5130	865 870 B	865 870 D	865 871 B	865 871 D	864 871 B	864 871 D

KTP 1000		1 pump with float switch		1 pump with SDS-Control Unit		2 pumps with SDS-Control Unit	
Installation depth D in mm	Art. #	Art. #		Art. #		Art. #	
		Class A/B	Class D	Class A/B	Class D	Class A/B	Class D
D 1	1630 - 2130	867 810 B	867 810 D	867 811 B	867 811 D	866 811 B	866 811 D
D 2	2130 - 2630	867 820 B	867 820 D	867 821 B	867 821 D	866 821 B	866 821 D
D 3	2630 - 3130	867 830 B	867 830 D	867 831 B	867 831 D	866 831 B	866 831 D
D 4	3130 - 3630	867 840 B	867 840 D	867 841 B	867 841 D	866 841 B	866 841 D
D 5	3630 - 4130	867 850 B	867 850 D	867 851 B	867 851 D	866 851 B	866 851 D
D 6	4130 - 4630	867 860 B	867 860 D	867 861 B	867 861 D	866 861 B	866 861 D
D 7	4630 - 5130	867 870 B	867 870 D	867 871 B	867 871 D	866 871 B	866 871 D

Submersible pumps



Ecolift® wastewater lifting system
for interior installation

Lifting stations
for interior installation

Lifting stations
for exterior installation

Submersible pumps

Submersible pumps for wastewater without sewage

Illustration and dimensioned drawing

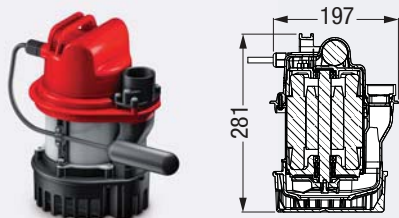

Article description

Submersible pump **KTP 1000**

with/without float switch

Connection to pressure pipe 1 1/4 inch.

Outlet side / vertical.

Voltage: 230 V ~ 50 Hz
 Intake power: 1000 W
 max. pumping height: 11 m
 max. pumping capacity: 12 m³/h
 Max. submersible depth: 10 m
 Max. particle size: 10 mm
 Pressure connection: 1 1/4 inch side / vertical
 Cable length: 10 m



CE EN 12050-1

**Model
without float switch**

1 1/4 inch 28 760

**Model
with float switch**

1 1/4 inch 28 860



Submersible pump **KTP 500**

with/without float switch

Connection to pressure pipe 1 1/4 inch.

Outlet side / vertical.

Voltage: 230 V ~ 50 Hz
 Intake power: 500 W
 max. pumping height: 8 m
 max. pumping capacity: 8.5 m³/h
 Max. submersible depth: 10 m
 Max. particle size: 10 mm
 Pressure connection: 1 1/4 inch side / vertical
 Cable length: 10 m



CE EN 12050-1

KTP 500:

**Model
without float switch**

1 1/4 inch 28 710

**Model
with float switch**

1 1/4 inch 28 810

KTP 500 TITAN

**Model
without float switch**

1 1/4 inch 28 750

**Model
with float switch**

1 1/4 inch 28 850

Performance diagram **KTP 500 / 1000**

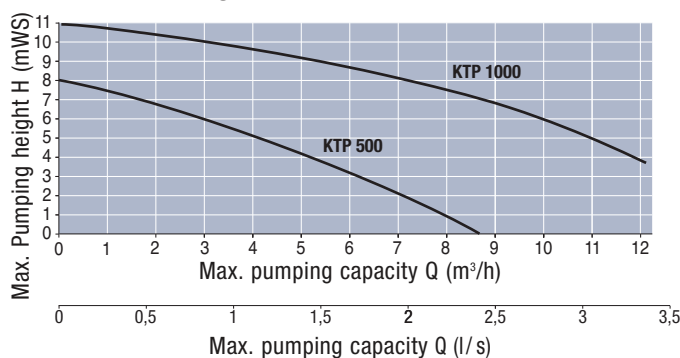

	KTP 500	KTP 1000
Current type	Alternating current	Alternating current
Voltage	230 V	230 V
Current	2.12 A	4.9 A
Motor rating P1/P2	480 W / 320 W	1000 W / 550 W
RPM	2800 min ⁻¹	2800 min ⁻¹
Motor protection	integrated	integrated
Operating mode	S1	S3 - 30%

Submersible pumps for wastewater without sewage

Illustration and dimensioned drawing

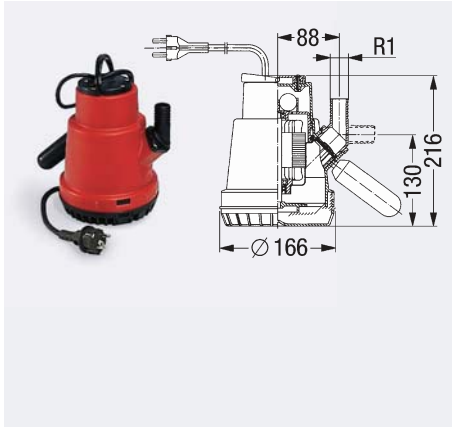

Article description

Submersible pump **KTP 300**

with/without float switch

With backwater flap, pivotable connection.

Motor rating: P1 300 W.
Voltage: 230 V ~ 50 Hz.
max. pumping height: 6.2 m.
max. pumping capacity: 8 m³/h.
Max. submersible depth: 10 m.
max. particle size: 10 mm.
Pressure connection: 1 inch side / vertical
Cable length: 10 m.

Removable intake basket - reduction in the water level to 8 mm possible.



Art.

Model without float switch

1 inch 28740

Model with float switch

1 inch 28840

Performance diagram **KTP 300**

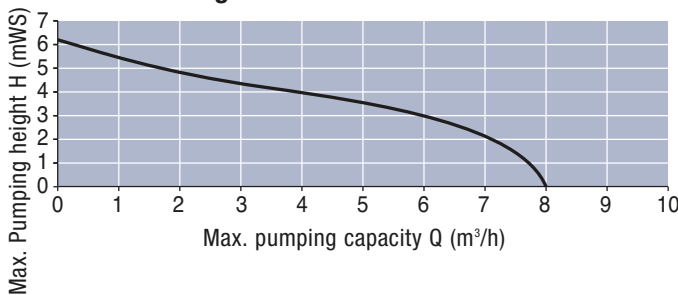

Pumping capacity Q (m ³ /h)	0.0	0.6	2.7	4.4	5.7	6.7	7.3	8.0
Pumping capacity (l/s)	0.0	0.17	0.75	1.2	1.6	1.9	2.0	2.2
Pumping height H (mWS)	6.2	5.8	4.5	3.8	3.0	2.5	2.0	0.0

Current type	Voltage	Current	Motor rating P ₁ / P ₂	RPM	Motor protection	Plug
Alternating current	230 V	1.9 A	280 W / 114 W	2800 min ⁻¹	integrated	Schuko

