

BEARING WET SUMP

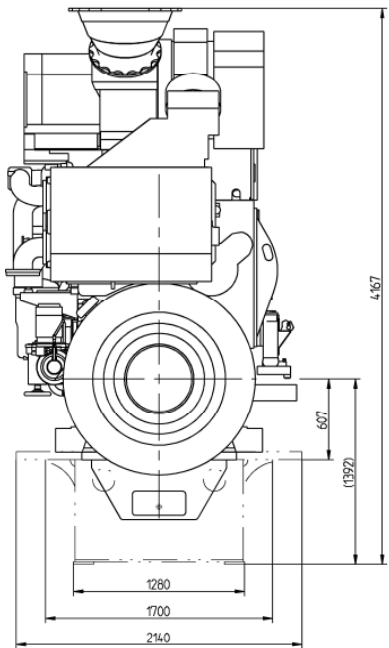

WET SUMP

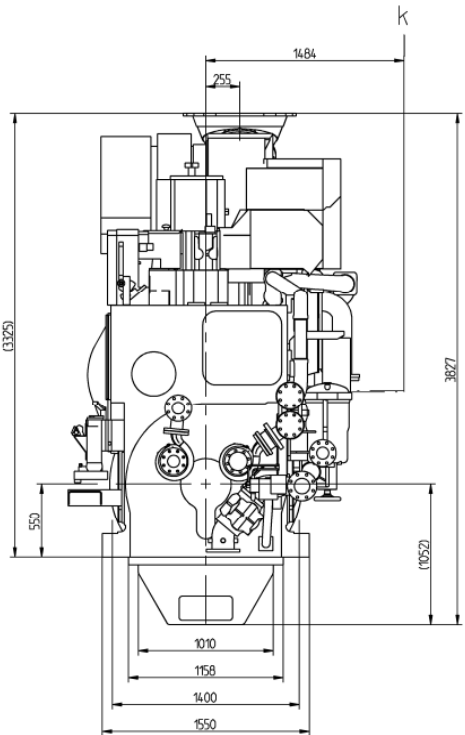
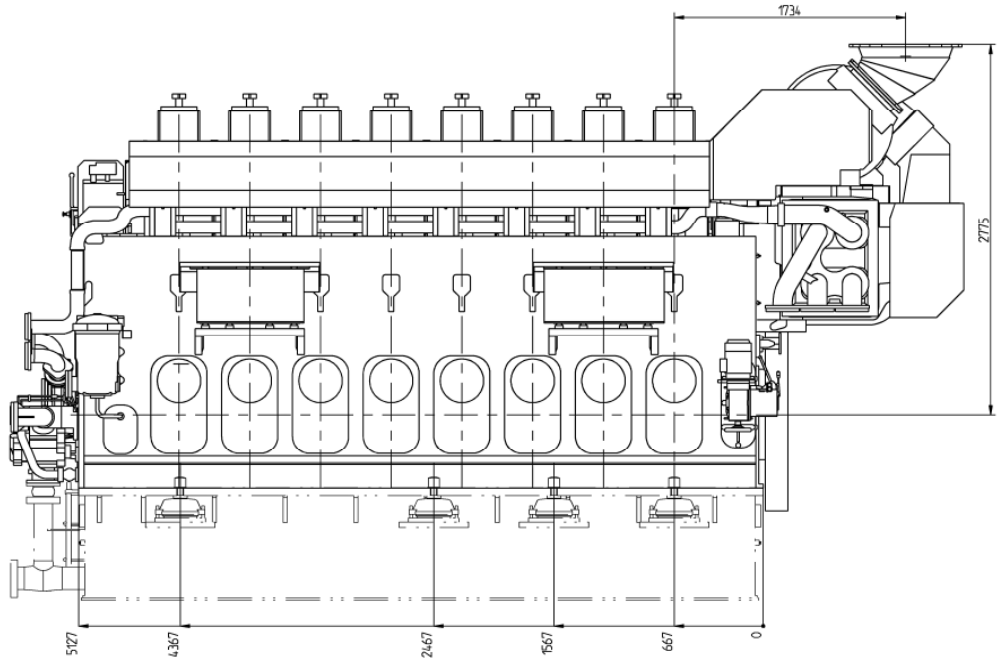

DRY SUMP

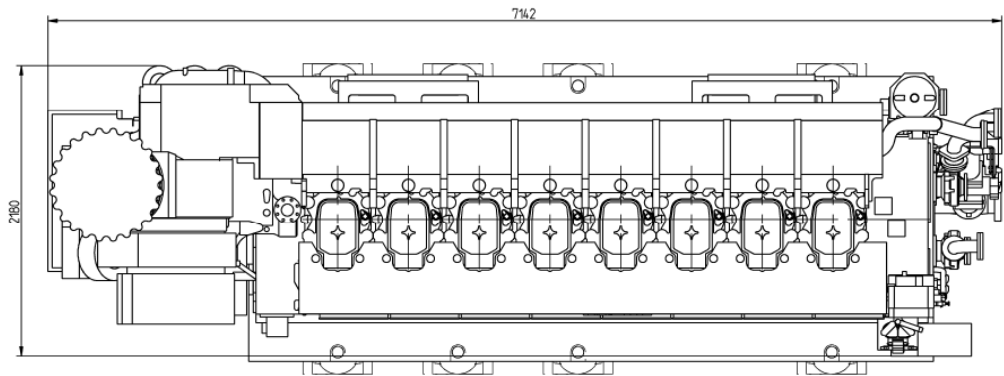
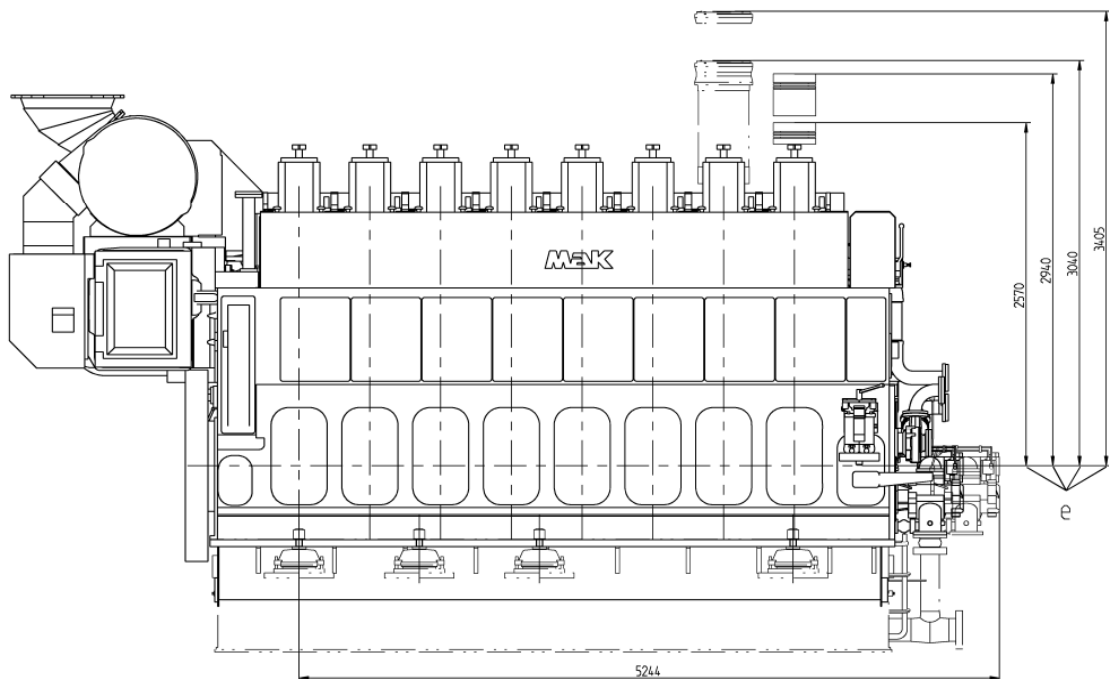

Anmerkung / REMARKS			
b SPACE REQUIRED FOR MEASURING TORSIONAL VIBRATIONS, AND/OR FOR REMOVAL OF THE VIBRATION DAMPER AND/OR LUBOIL PUMP			
e SPACE REQUIRED FOR REMOVAL OF PISTON AND CYLINDER LINER			
REDUCED REMOVAL HEIGHT FOR CYLINDER LINER 2940mm			
k SPACE REQUIRED FOR TERMINAL SET			
o SPACE REQUIRED FOR TURBOCHARGER SHAFT			
p SPACE REQUIRED FOR CHARGE AIR COOLER REMOVING			

Gewicht trocken mit flacher Ölwanne
WEIGHT DRY WITH DRY SUMP

CATERPILLAR MOTOREN GmbH & Co. KG RESERVES THE RIGHT TO
MODIFY AND AMEND DATA AT ANY TIME. ANY LIABILITY FOR
ACCURACY OF INFORMATION PROVIDED IS EXCLUDED.
WE WILL SUPPLY FURTHER BINDING DATA IN CONNECTION WITH A CORRESPONDING ORDER.

ALL RIGHTS RESERVED. NO PART OF THIS PUBLICATION
MAY BE REPRODUCED OR COPIED IN ANY FORM,
WITHOUT PRIOR WRITTEN PERMISSION OF CATERPILLAR MOTOREN GmbH & Co. KG.

CATERPILLAR		Modell 8M34DF-FWS 1.0	
Oberflächen Surfaces ISO 1802		Allgemeinsprachen General languages ISO 2768 - mK	
Benennung Name		Zeichnung Drawing W 882	
Änd.-Stand Change Level		Freigabe-Nr. Release No.	
—		UKZ Doc Code	
		Zeichnungs-Nr. Drawing No.	
		Blatt Sheet	
		1	
		8M34DF FWS	
		~49000	